

## Assembly Instruction

Step 1 :

Lay unit in horizontal position

Step 2 :

Hook SPRING (#3) into spaces provided in BRIDGE(#10)

Step 3 :

Slide JACK SUPPORT(#4) up FRAME(#1) and attach hooks to SPRING(#3)

Step 4 :

Slide PRESS TABLE (#5) up frame and support in position with TABLE PIN(#6) with table lifting handle up.

Step 5 :

Bolt BASE(#2) to bottom of FRAME(#1) with four nuts and bolts provided.

Step 6 :

Carefully lift unit to upright position.

Step 7 :

Place JACK(#9) in position between JACK SUPPORT(#4) and BRIDGE (#10)

Step 8 :

To operate insert table pins at desired height in frame and place press table on top of pins.

Step 9 :

ARBOR PLATE (#7) and/or PLATE SUPPORT(#8) may be used in operation.

Step 10 :

A three piece JACK HANDLE (#11) is also provided for use of jack. To operate, turn valve clock-wise using end of handle, the pump jack, to release pressure turn valve counter- clockwise.

Notice: Jack is designed for operation with shop press specifically. DO NOT attempt to use jack outside of press.

## Parts List

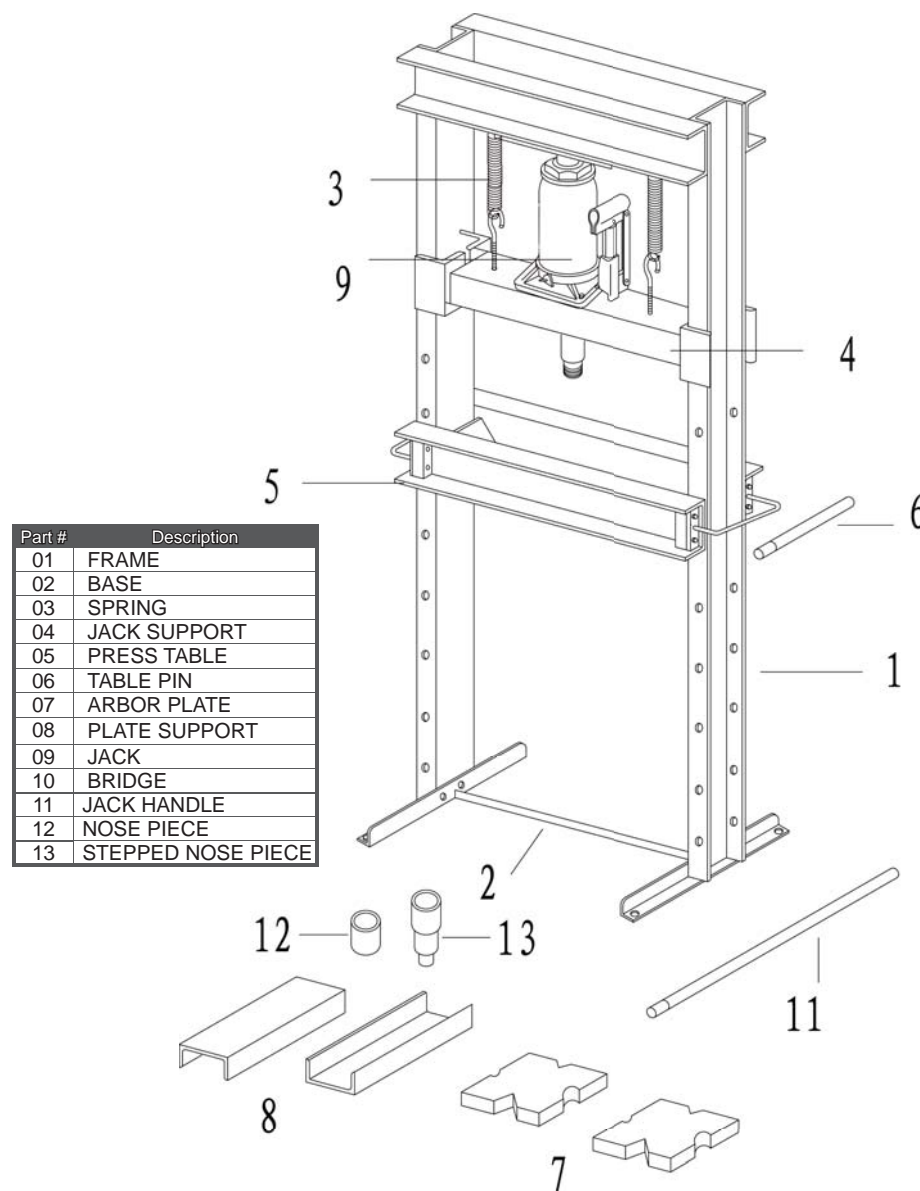

\* We reserve the right for any designing to the parts and without anynoticement in advance.